

# TW30000

## INTERCHANGEABLE PRODUCTS:

- Rice Lake RL20000
- Revere Transducers 9363
- Artech SS20210

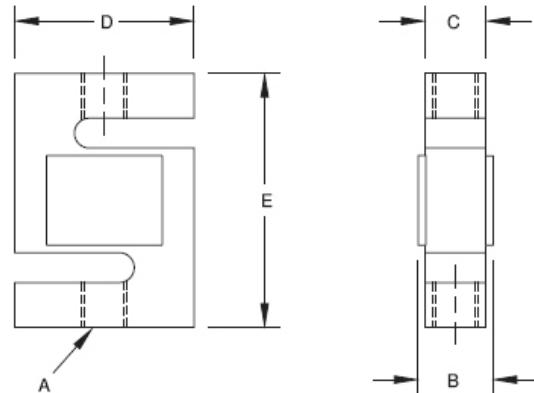

## DIMENSIONS

Rated Capacity	A	B	C	D	E
lb/inches					
500-1500	1/2-20 UNF-2B	1.00	.75	2.00	2.50
2000-2500	1/2-20 UNF-2B	1.25	1.00	2.00	2.50
5000-10,000	3/4-16 UNF-2B	1.25	1.00	3.00	4.00
15,000	1-12 UNF-2B	1.50	1.25	4.00	5.50
25,000	1 1/4-12 UNF-2B	2.25	2.00	5.00	7.00
kg/mm					
226.8-680.4	1/2-20 UNF-2B	25.4	19.1	50.8	63.5
907.2-1134.0	1/2-20 UNF-2B	31.8	25.4	50.8	63.5
2268.0-4535.9	3/4-16 UNF-2B	31.8	25.4	76.2	101.6
6803.9	1-12 UNF-2B	38.1	31.8	101.6	139.7
9071.9	1 1/4-12 UNF-2B	57.2	50.8	127.0	177.8

## SPECIFICATIONS

Full Scale Output: 3.0mV/V nominal  
 Bridge Resistance: 350 ohms, nominal  
 Temperature: Compensated range  
 14 deg. F to 104 deg. F  
 -10 deg. C to 40 deg. C  
 Safe Overload: 150% Full Scale  
 Rated Excitation: 10V DC (15V maximum)  
 Nonlinearity: 0.03% Full Scale

Insulation Resistance: 5000megohms  
 Cable Length: 20' / 6.1m  
 Cable Coloring: Red...+Excitation  
 Black...-Excitation  
 Green...+Signal  
 White...-Signal  
 Warranty: 1-year limited warranty  
 Hysteresis: 0,02% Full Scale

# TECHWEIGH