

# TWS -K 102 Load Cell

The Model TWS-K102 is a high accuracy, strain gage load cell. The load cell body style and capacities are specifically designed for crane applications. The Tech Weigh load cell is available in capacities from 6.3 tons to 160 tons. High temperature construction and high temperature cable options are available up to 400 deg. F. Custom load cells can be provided to fit specific applications.

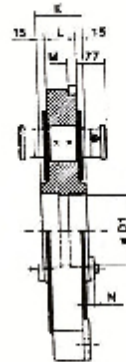

TWS-K 102  
6.3T - 25T

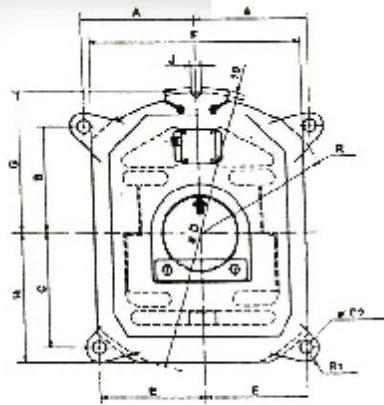
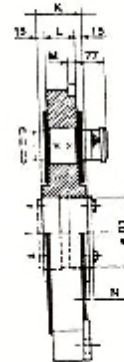
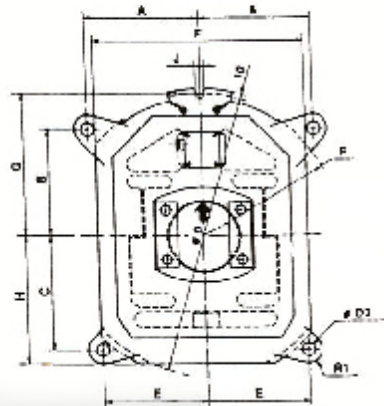

TWS-K 102  
40T - 160T

## Dimensions (mm)

Metric Tons	A	B	C	D	D1	D2	E	F	G	H	J	K	L	M	N	R	R1
6.3	145	175	180	400	80	20	140	320	200	190	16	80	50	15	10	195	20
10	180	175	190	450	100	24	165	350	225	215	20	100	70	20	10	220	25
16	210	180	195	500	120	24	195	410	250	225	20	100	70	20	10	245	25
25	240	225	245	600	160	30	220	450	300	275	20	100	70	20	12	295	30
40/63	295	240	255	700	200	30	280	550	350	315	28	120	90	20	12	345	30
100	325	285	300	800	240	38	310	580	400	320	28	150	120	25	15	395	35
160	360	325	345	900	280	38	340	650	450	390	32	150	120	25	15	445	35

