

TWS-L105 Load Cell

The Model TWS-L105 is a strain gage load cell that directly replaces the QGPL-105 ABB Pressductor electromagnetic load cell. The replacement cells will have the same body style and capacities as the ABB cells. The Tech Weigh load cell will replace all these capacities: -5 tons to 160 tons. The load cell utilizes the same cable, so no need for new cable runs. High temperature compensation and high temperature cable options.

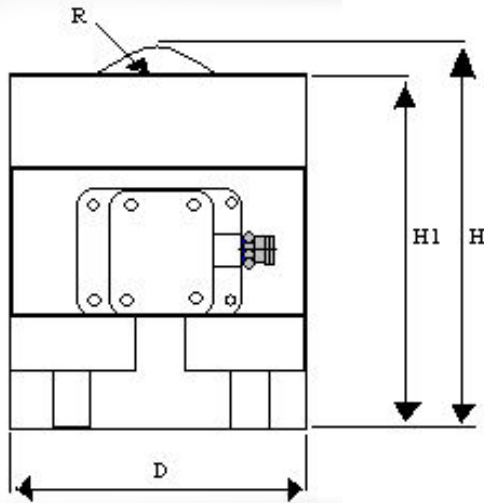

| Metric Tons | D | H | H1 | R |
|-------------|-----|-----|-----|-------|
| 5 | 132 | 160 | 148 | 19.00 |
| 10 | 143 | 175 | 161 | 25.40 |
| 16 | 154 | 185 | 169 | 31.75 |
| 25 | 184 | 195 | 179 | 31.75 |
| 40 | 204 | 230 | 214 | 31.75 |
| 63 | 224 | 255 | 237 | 38.10 |
| 100 | 245 | 270 | 252 | 38.10 |
| 160 | 295 | 310 | 292 | 38.10 |

SPECIFICATIONS:

Full Scale Output: 3m V/V
 Bridge Resistance: 700 ohms, nominal
 Material: High-Alloy Steel
 Temperature: Range 0 to 150 deg. F
 High temperature available to 550 deg. F
 Safe Overload: 150%
 Maximum Overload: 300%
 Rated Excitation: 20V AC/DC

Combined Error: 0.10% F.S.
 Non-Repeatability: 0.03% F.S.
 Insulation Resistance: 5000 megohms
 Standard Cable Length: 25 ft.
 Color Code: +Excitation-Red
 -Excitation-Black
 +Signal Green
 -Signal White

TECH WEIGH